

Varioverse™

HDC - Manual



# Content

<i>Varioverse™</i>	<b>3</b>
<i>Parts</i>	<b>4</b>
<i>Tippet / Line strength</i>	<b>5</b>
<i>Setting the Maximum Drag</i>	<b>6</b>
<i>Spool Change</i>	<b>8</b>
<i>Tuning the Minimum Drag</i>	<b>9</b>
<i>Disassembly</i>	<b>10</b>
<i>Maintenance</i>	<b>11</b>
<i>Retrieve Change</i>	<b>12</b>

and for (even) more info, visit:  
[www.varioverse.com](http://www.varioverse.com)

# Varioverse™

Varioverse™ is an unique Drive & Drag system patented by Chivarov:  
 EP 1993353, US 7,694,907  
 It allows you to safely reel and intuitively control the drag force by merely turning the handle.

## Basic Operation

When you reel-in against the fish pull, the drag increases simultaneously. If the fish pulls over a certain drag level, the spool starts slipping back in relation to the driving handle thus protecting your fingers and tackle. By turning the handle back you can decrease the drag at any time in order to play the fish. Turning the handle fully back provides a minimum (stripping) drag for casting again.

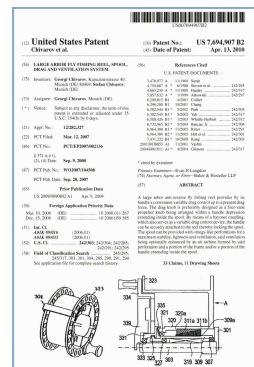
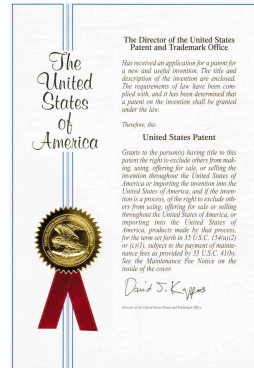

# Parts

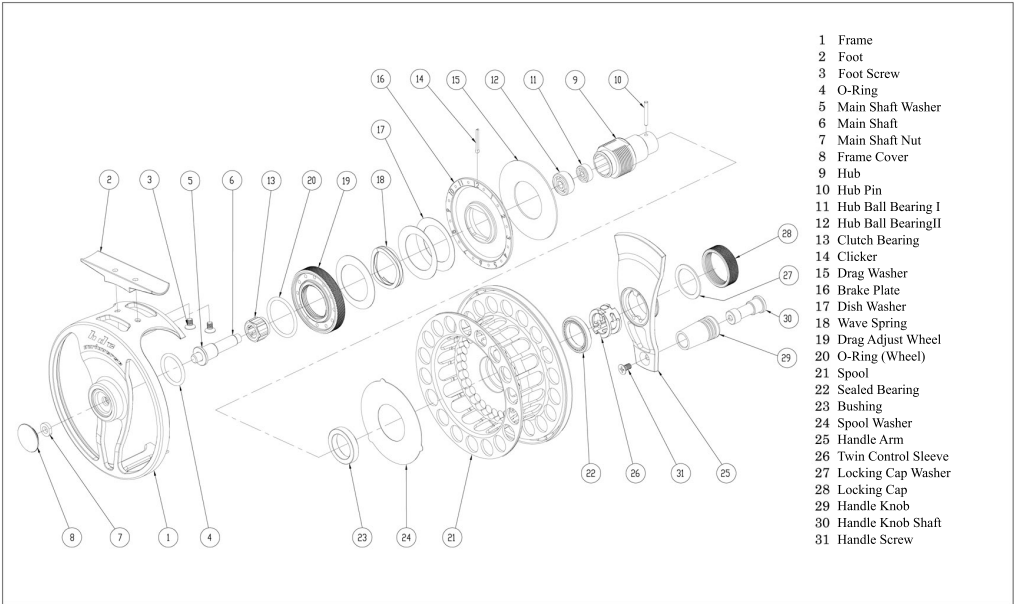

or visit [www.varioverse.com/pdf/hdc\\_parts\\_en.pdf](http://www.varioverse.com/pdf/hdc_parts_en.pdf)

# Tippet / Line strength

Our testing has revealed that the advertised tippet/line strength is often not equal to the actual strength under fishing conditions. It depends on such factors like aging, weathering (incl. exposure to UV-light), knots, amount of impulse and steady stress during a fight. Therefore **it is very important to consider this and test your tippet/line before choosing and setting the maximum drag.**

You can do so on your own by attaching different weights on the tippet / line hanging from the reel and determine the actual static braking strength. Your maximum drag should be not more than 50 % of that strength.

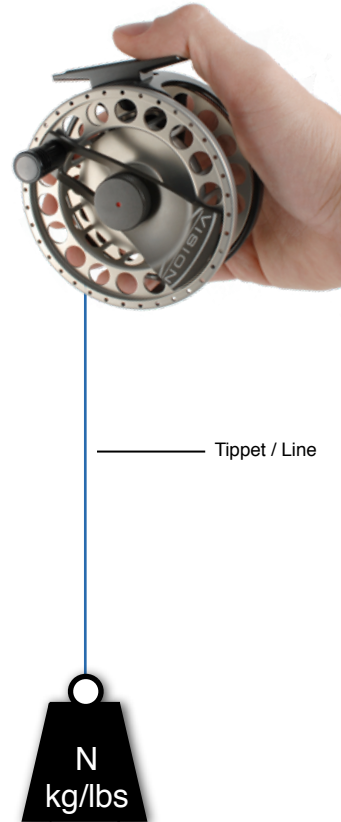

# Setting the Maximum Drag

**The maximum drag is to be set before fishing** in order to protect your tackle during a fight. Therefore it should be set corresponding to your weakest tackle component, whether tippet or line.

For setting the maximum drag proceed according to the following steps:

1. Turn the Handle (25) fully back and hold it together with the Spool (21) and Frame (1) with one hand, **screw-in the Wheel (19)** with the other hand as far as it goes, then **rewind one full turn back**. With this a maximum drag is pre-set.



2. **Hold the Spool and Frame together** with one hand and turn the Handle forward with the other hand until you hear a \*click\* which means you have reached the maximum drag; then pull line out of the Spool or **turn the Spool backwards by hand**, while holding the Frame with the other hand in order to test if the pre-setting meets your expectations. (see [Tippet / Line Stenght](#))
3. If you consider the pre-setting too low or too high, turn the Handle fully back and slightly turn the Wheel in to increase or out to decrease the maximum drag.

Once you have found the perfect setting, remember the number on the back of the Drag Plate (16) opposite to the **red dot** index on the Wheel.

This way the re-setting after a spool change will be fast and precise.

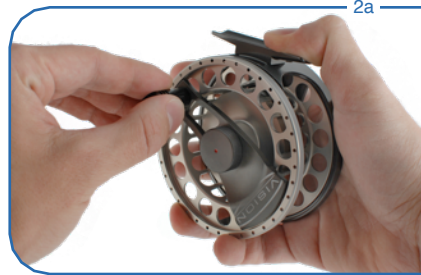

2a

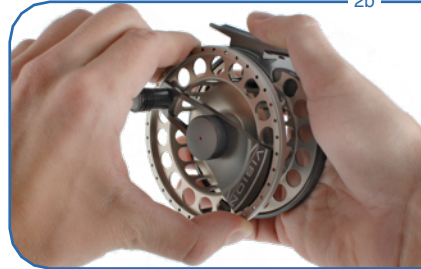

2b



red dot

# Spool Change

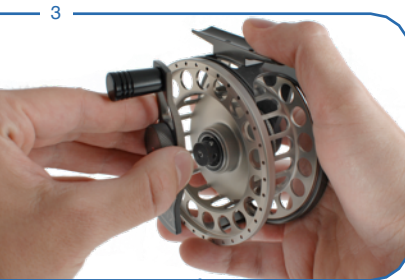

To remove and change the Spool:

1. Turn the Handle (25) fully back and unscrew the Wheel (19) until it slightly abuts the Frame (1).
2. **Push & turn the Handle backward** while holding the Spool (21) and Frame together so as to unlock the Handle, then slip the Handle and Spool out from the Hub (9).
3. Change the Spool, **slide the Handle onto the hub and align it with the Hub Pin (19), push & turn the Handle forward**, then set your maximum drag accordingly. (see [Setting the Maximum Drag](#))

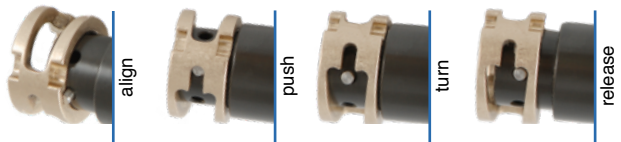

# Tuning the Minimum Drag

The preferred minimum drag may change, depending on the stripping drag preference. There is an easy way to tune that:

1. Remove the Handle (25) and Spool (21). (see Steps 1 and 2 in [Spool Change](#))
2. The Hub Pin (10) has two more possible settings for which separate holes are provided on the Hub (9).
3. **Move the Hub Pin to one of the other two settings** by unscrewing it with the tool that came with your reel. Make sure the Hub Pin protrudes equally on both sides of the Hub before screwing it tight.

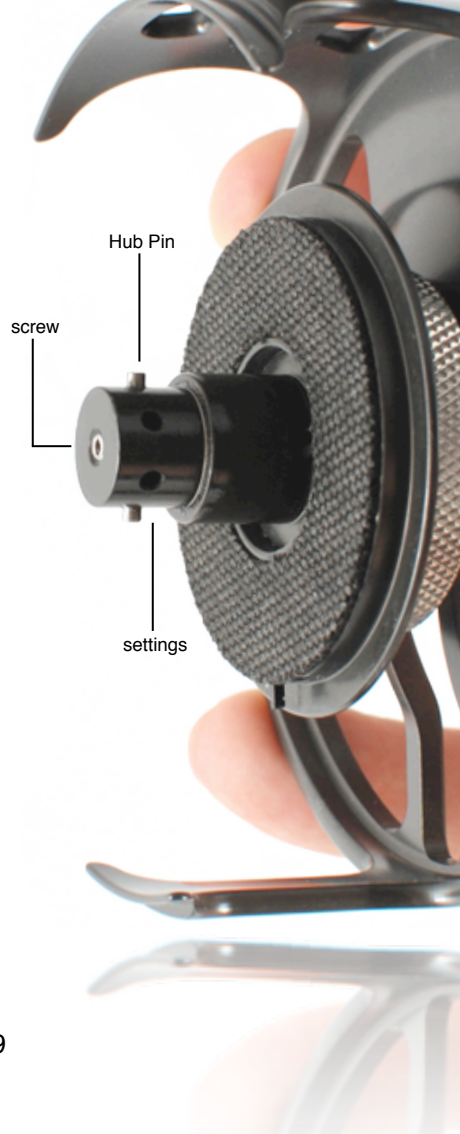

# Disassembly

2



No tools, just your hands and a few seconds:

1. Remove the Handle (25) and Spool (21). (see Steps 1 and 2 in [Spool Change](#))
2. **Click-out the Drag Unit (9-20)** from the frame axle by pressing it with your thumbs from the frame side.
3. Unscrew the Wheel (19) completely, remove Springs (17-18) and Brake Plate (16).

When putting the reel back together, **make sure the Dish Washers (17) face each other like brackets.**



1 x Dish Washer ) \_\_\_\_\_  
Wave Spring \_\_\_\_\_  
2 x Dish Washers ( ( \_\_\_\_\_

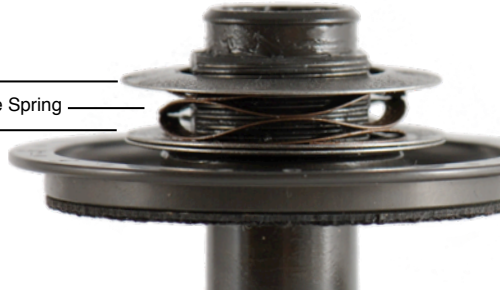

# Maintenance

The HDC Varioverse does not require much maintenance.

Just keeping the reel clean is enough, but rinsing it after use is recommendable.

After saltwater use it is advisable to clean the reel with more care. Brake it down into its parts, then rinse all, except for:

- the inner side of the **Hub** (9)
- the **Clutch** (13)

with fresh water and leave them to dry.

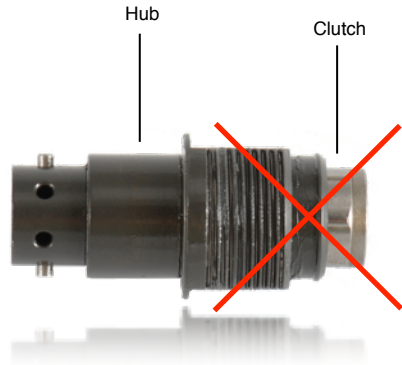

# Retrieve Change



Left? Right? Whatever, you can do it in seconds:

1. Remove the Handle (25) and Spool (21). (see Steps 1 and 2 in [Spool Change](#)) Then **unscrew the Cap (28)**, **pull out the Sleeve (26)** and turn it around; put the Cap back in order to fix the Sleeve in its position.
2. Click-out the Drag Unit (9-20) from the frame axle by pressing it with your thumbs from the frame side, then pull the Clutch (13) out and turn it around; click-in the Drag Unit back into its place.
3. Put the Spool back on and lock it with the handle. (see Step 3 in [Spool Change](#))

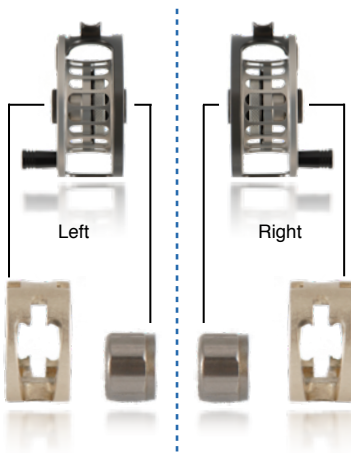

**Turn Sleeve and Clutch as shown.**